

## Seed Beaded Tennis Bracelet



Skill Level Beginner

Time Required: 1 hour

### Supplies

John Bead Size 6/0 Czech Glass Seed Beads, choose one color

John Bead Size 8/0 Czech Glass Seed Beads, choose one color

John Bead Size 11/0 Czech Glass Seed Beads, choose one color

Wildfire Beading Thread .006 SKU 10470337

Size 10 Beading Needles SKU 10332394

Clasp, such as a Toggle or Lobster Claw SKU 10103710

### Tools Needed:

Precision Scissors SKU 10591717

Bead Mat SKU 10348546

## Instructions

Cut approximately 36" of Wildfire Beading Thread and thread your needle onto one end.

### Step 1

Leaving a 10 to 12 inch tail, string a size 8/0, 6/0 , and 8/0 seed bead.

### Step 2

Pick up three, size 11/0, one 8/0, and three more size 11/0 seed beads. Go back through the first three beads added. These beads are re-ferred to as the "core beads".

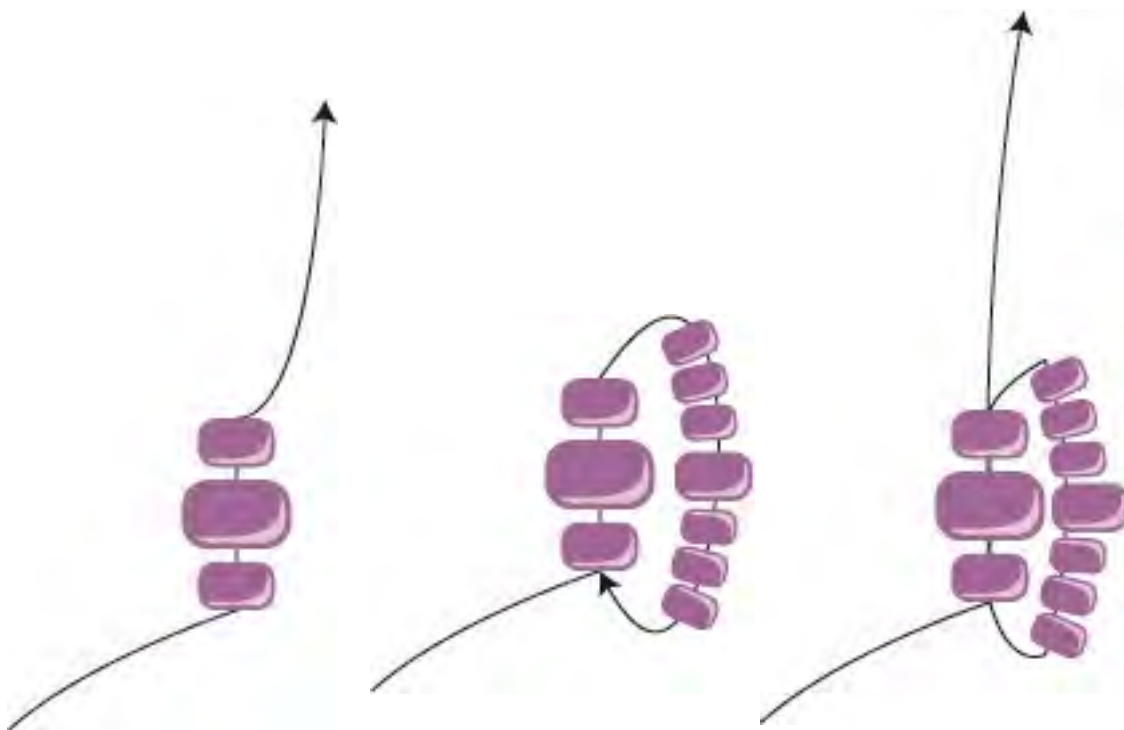

### Step 3

Pick up three size 11/0, one 8/0, and three size 11/0 beads. Go back through the three core beads again. Position this new set of side beads on the left.

### Step 4

Pick up a size 6/0 bead and a size 8/0 bead. These are new core beads.

### Step 5

Pick up three size 11/0, one 8/0, and three size 11/0.

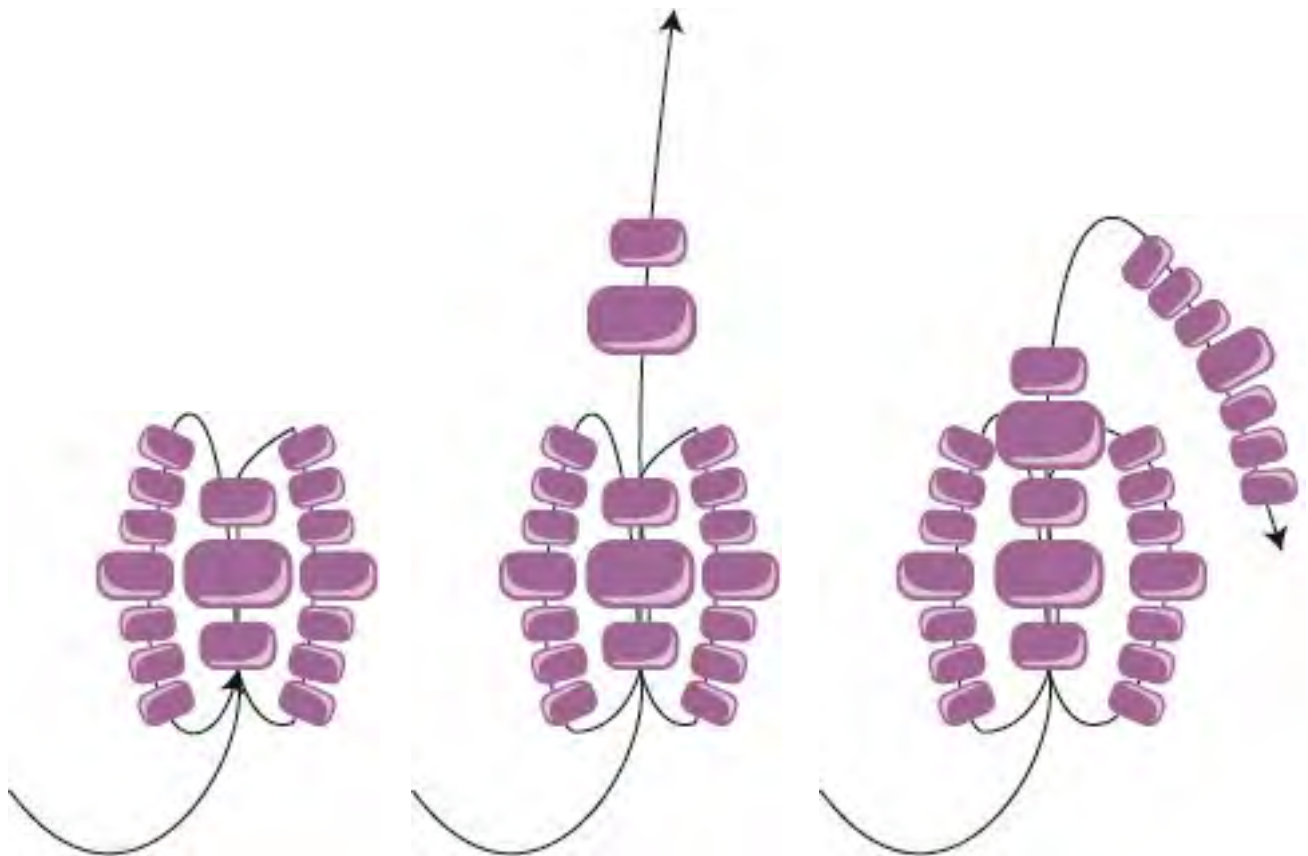

### Step 6

Go through the core beads shown. Position the new side beads on the right and pull tight. The new beads will sit on top of the former layer.

### Step 7

Pick up another set of beads (three 11/0, one 8/0, and three 11/0) and come up through the core beads again. Position this new side layer on the left.

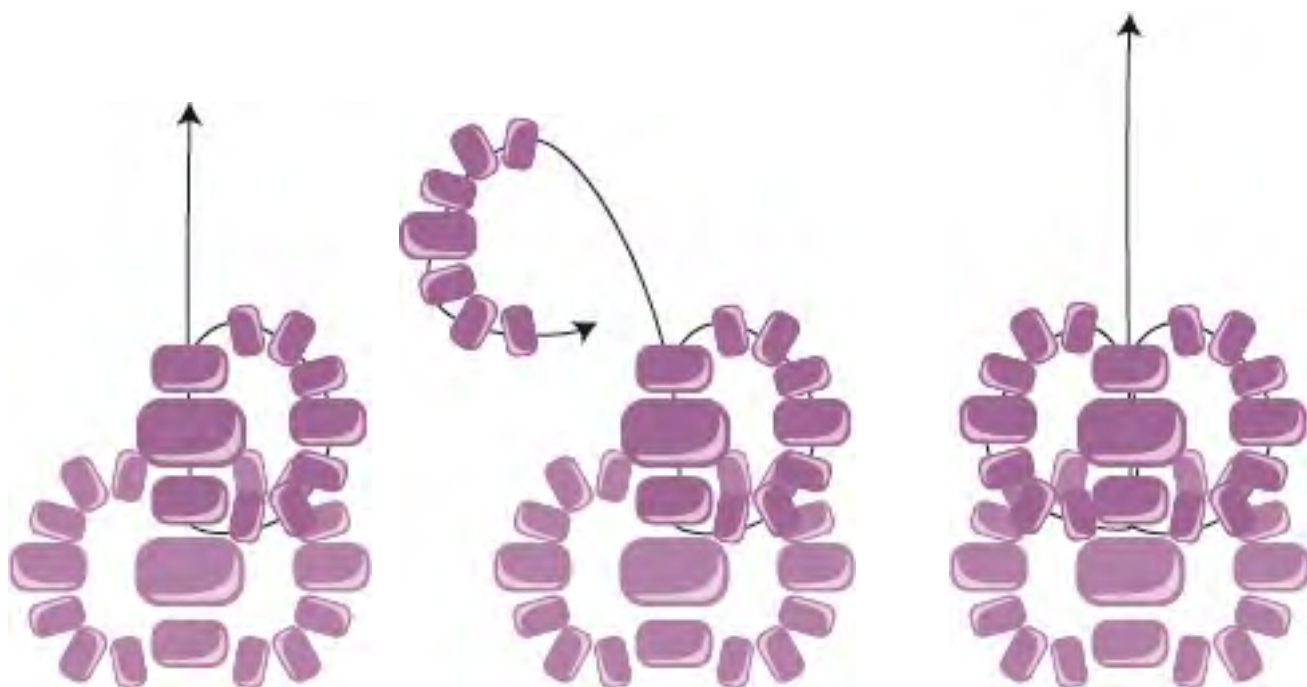

### Step 8

Continue this pattern by repeating steps 4-6 for the length of your bracelet.

Measure your bracelet as you stitch until you have reached the desired length for your bracelet. The clasp usually adds about an inch, depending on type.

### Step 9

Add your clasp by picking up one more size 8/0 bead and three size 11/0. Go through the loop of your clasp and then pick up three more 11/0. Go down through the 8/0 bead.

### Step 10

Continue through the next three core beads, side three 11/0, 8/0, and three 11/0 beads. Then go up through the 8/0 bead and loop through all the beads attaching the clasp. Go down through the 8/0 bead and three core beads, loop through the other set of side beads, and continue back up through the 8/0 bead and clasp beads. To finish, go back down through the 8/0 bead and into the core beads below.

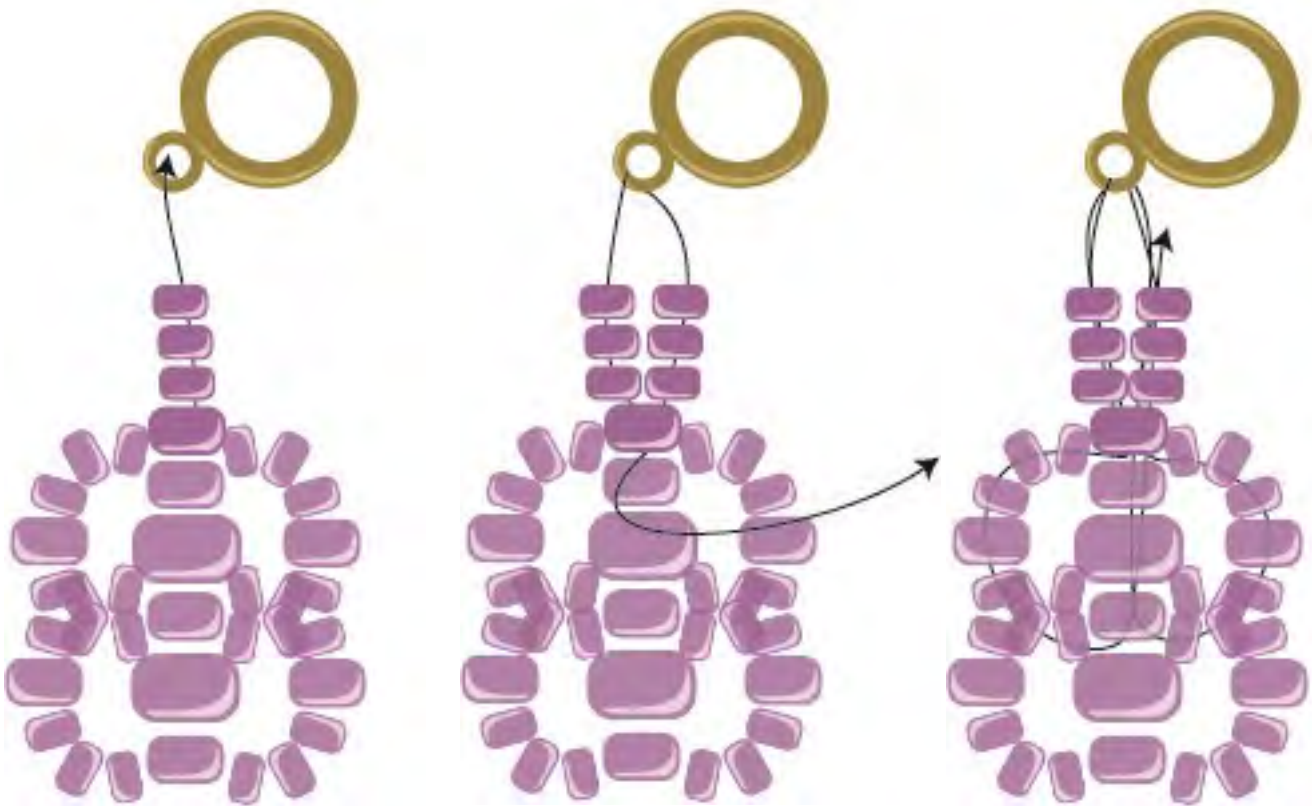

### Step 11

Weave in thread by following the thread path through several repeats of core beads and side beads. Trim thread and repeat this step on the other side of your bracelet.